

# Cell Box Prime

T-Mobile SIM Card Included at No Charge for easy activation.

## RANGE

Access Control

### BFT CELLULAR CALL BOX WITH KEYPAD

BFTCELL-PRIME  
BFTCELL-PRIME-NK  
BFTCELL-PRIME-E



- Open gates from your phone.
- Built in time clock control.
- Remotely program your keypad codes by app.
- Automatic 7-day timer controlled by the app.
- Activity log (see who opened your gates and when).
- Access your property by telephone, caller ID (known number), SMS, or pin code.
- 15V DC power supply adaptor included.
- Built-in illuminated keypad with 200 codes, 20-time zone codes, 30-temporary codes.
- 100 Registered caller id users.
- Get a call from your cellbox anywhere in the world.
- Three year limited warranty.

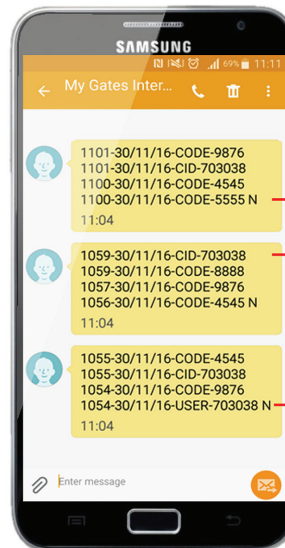

**CODE:** Keypad code used, with date and time!

**CID:** Caller ID user with last 6 digits of phone number shown!

**USER:** Home user, opened their gates at this time and date.



BFT Cellbox Prime

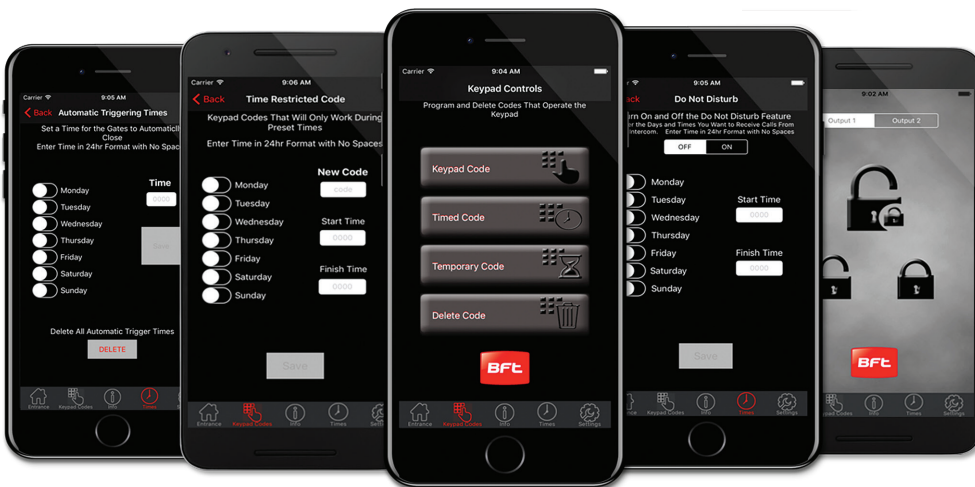



**Accessories for Low Signal Areas:**  
RX489WB- Yagi antenna  
J195SN20- Cable for yagi antenna



# Cell Box Prime



## PHYSICAL MEASUREMENTS

### BFTCELL-PRIME

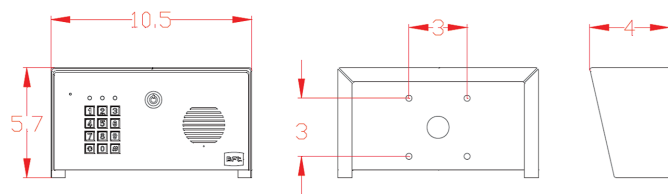

### BFTCELL-PRIME-E

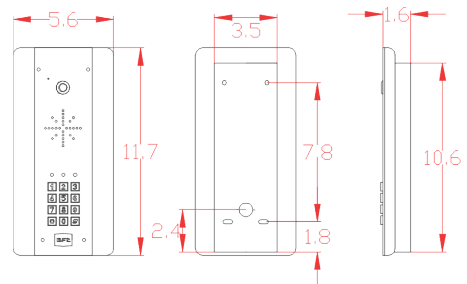

## TECHNICAL DATA

BFTCELL-PRIME  
 BFTCELL-PRIME-NK  
 BFTCELL-PRIME-E

### GENERAL:

Voltage: 15v dc  
 Recommended cable @ 25 feet: 14 gauge  
 Solar compatible: Yes  
 Current on standby: Operating 55mA  
 Current: 330mA  
 Peak Demand Current: Internal Fuse 2 Amps  
 Rating: 500mA quick blow

### CELLULAR MODULE:

Relays: 2 relays, max 2 amps, 24v ac/dc load  
 Latching: Yes  
 Caller ID users: 100  
 Programming: SMS & APP  
 Network compatibility: AT&T, T-Mobile

### KEYPAD CODES:

Standard codes: 200  
 Time zoned codes: 20  
 Temporary codes: 30

